

The ESS **Advancer V-12™** is a revolution in low-profile, functional eye protection. Equipped with the patented **AVS™ Adjustable Ventilation System**, the lenses click open and closed to regulate ventilation, increasing or decreasing airflow on the move. For the first time ever, a goggle can adapt to its environment with a simple click of the lenses.



Like all ESS eyewear, the **Advancer V-12™** has high-impact polycarbonate lenses that provide distortion-free optical quality and 100% protection from harmful UVA / UVB rays.



AVS™ Adjustable Ventilation System



The patented ESS **Adjustable Ventilation System™** allows users to regulate airflow on the move. “Advancing lenses” click open to initiate maximum airflow and eliminate lens fogging, or snap closed to seal out airborne particles.

- 1) **For maximum airflow**, open the advancing lenses by moving the outer lens module forward (away from the main frame) until the latch clicks into its open position.
- 2) **For maximum filtration**, close the advancing lenses by pushing the lens module toward the main frame until it clicks into its closed position.

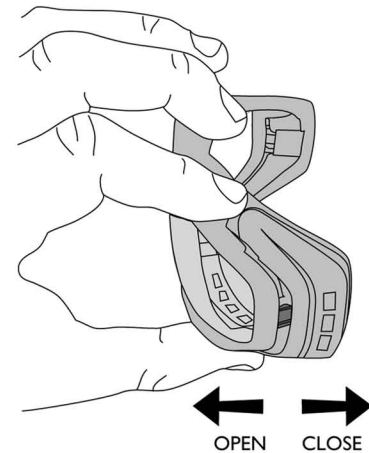

Lens Removal



- 1) To remove an **Advancer V-12™** lens module, first pivot the lens module forward to the open position. Next, from inside the goggle, disengage the lens module latch by first pulling it towards the inside of the goggle, then pushing this latch forward and out until it separates from the main frame guide track.
- 2) Pivot the lens module forward and separate it from the main goggle frame at the hinge.

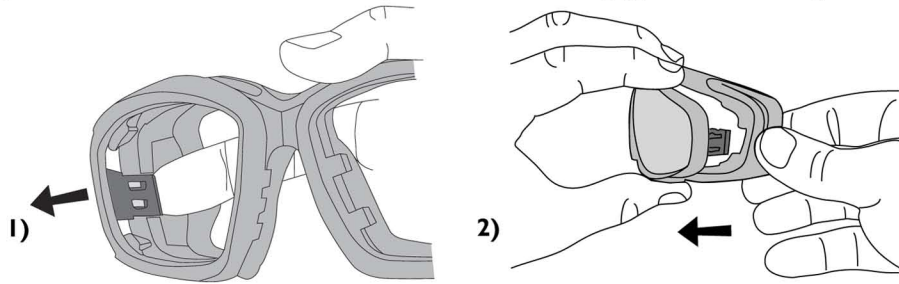

Lens Installation



- 1) To insert an **Advancer V-12™** lens, start with the outside edge of the lens module. Position the lens module latch into the main frame's guide track and snap into place by firmly pressing on the outside of the lens (Fig. 1).
- 2) Next, firmly press the inside edge of the lens module (the area above the hinge) in a **downward and inward direction toward the nose** (Fig. 2).

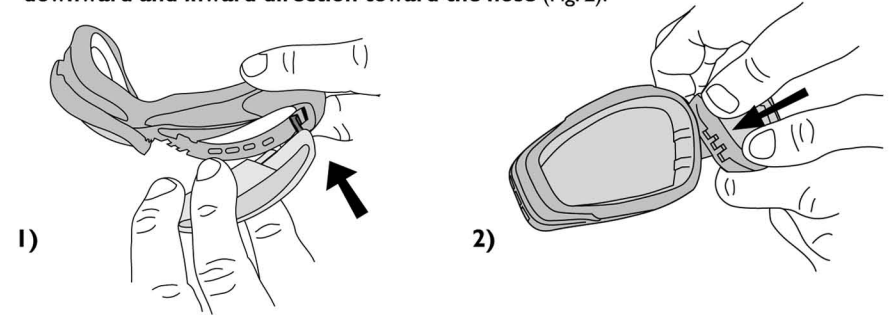

Strap Removal & Re-Attachment / Installing the SpeedSleeve™



There may be cases that require the removal of the strap. For example, to install the **SpeedSleeve™** (see accessories) you will need to remove, and subsequently re-attach, one side of the strap.

- 1) **To remove the strap**, first remove the lens frame from the main goggle frame. While holding the main goggle frame, rotate the strap clip forward, until the wings of the retaining pegs are aligned with the pivot hole (Fig. 1).
- 2) Pull one half of the strap clip until the retaining peg comes out of the pivot hole (Fig. 2).
- 3) Remove the other retaining peg.

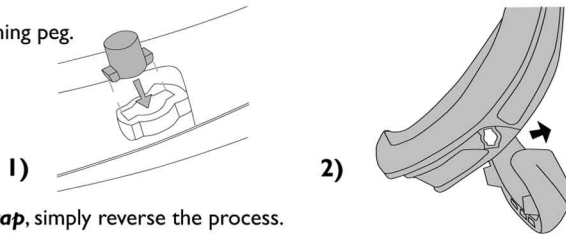

NOTE: **To re-attach the strap**, simply reverse the process.

Strap Adjustment



- 1) To tighten the strap, simply pull each of the 2 slide buckles evenly towards the frame.

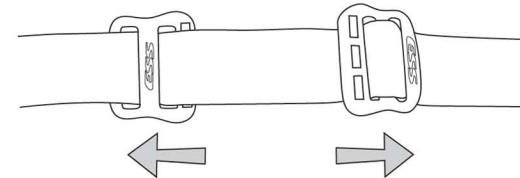

- 2) To loosen the strap, slide the 2 buckles evenly towards the center (rear) of the strap.

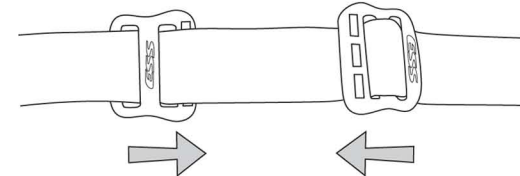

Accessories



V-12 Lens Pod™

The ESS **V-12 Lens Pod™** is a hard protective case for replacement lenses. The **Lens Pod™** is recommended for whenever lenses are not installed in the **Advancer V-12™**.



Anti-Reflective SpeedSleeve™

The ESS **SpeedSleeve™** eliminates lens glint and keeps the goggle and lenses clean & scratch-free when not being worn.



Maintenance



LENS CARE

ESS lenses have been specially coated to offer outstanding abrasion and fog resistance. Special care is required to keep them performing at their best.

- Clean the lens with water only. Do not use cleaners or solvents.
- Use a soft cotton or microfiber cloth and gently wipe clean. Never use paper products to clean the lenses. Avoid wiping the lens surface when it is dry and dirty as this may scratch the lens.
- Always keep replacement lenses in the ESS **V-12 Lens Pod™** to avoid damage to the lens.
- If the lens is cracked or severely scratched, replace the lens.

EYEWEAR CARE

- To clean the **Advancer V-12™**, remove the lens modules and clean separately. The frame and strap may be gently hand washed in a mild soap solution, rinsed, and air-dried.
- Store the eyewear in a cool, dry place away from direct sunlight.
- If the eyewear is stored on a helmet, loosen the straps to prevent stretching.

Applicable Standards



The **Advancer V-12™** meets all ANSI Z87.1-2003+ requirements for goggles and those of EN 166 B (medium energy, high-speed particles).

In either mode, the **Advancer V-12™** meets the .22 caliber high-velocity impact requirements of MIL-V-435 IIC.

This goggle Conforms to the European PPE Directive 89/686/EEC and EN 166:2001, EN 170 and EN 172. "This model is certified by: CERTOTTICA Scarl, Zona Industriale Villanova, 32013 Longarone (BL)-Notified Body number: 0530".

Caution!: This product does not provide for lateral protection of high-speed particles in the open vent position and as such should be used only in the closed vent position when risks from laterally-impacting high-speed particles are present.

LIMITED WARRANTY:

ESS warrants our products against defects in material and workmanship for one year from the date of purchase. Within the terms of this warranty, ESS will repair or replace, at our discretion, any product proving to be defective after our receipt and inspection.

Please contact ESS Customer Service for warranty information: ess@essgoggles.com.



CAUTION:

No protective eyewear can protect the wearer from all potential impacts. Although this product exceeds all of the ANSI Z87.1+ requirements, including those for impact resistance, this product WILL NOT protect against all impacts nor will it protect against all chemical splashes. If goggles are worn over standard ophthalmic spectacles when impacts occur, there may be an increased hazard to the wearer. Do not use in the sports of Paintball or Airsoft or in training exercises involving marking rounds. Materials that may come into contact with the wearer's skin could cause allergic reactions to susceptible individuals. Carefully read and follow the instructions.



ESS
Eye Safety Systems, Inc.

Eye Safety Systems, Inc.
P.O. Box 1017
Sun Valley, ID 83353, USA

Toll Free: 877.726.4072
International: +1.208.726.4072
Fax: +1.208.726.4563
E-mail: ess@essgoggles.com
Web: www.essgoggles.com

US Patents # 6,718,561 B2; #6,732,383 B2; # 6,047,410. International patents pending.
All trademark, copyright and other intellectual property rights reserved.

IEAINS07